

Wire Range	Insulation Diameter	Reel Q'ty
AWG #26~#30	1.40 (.055) MAX.	10,000 PCS.

Ordering Code :

$\frac{CD02}{①}$ 
 $\frac{T01}{②}$ 
 $\frac{A}{③}$ 
 $\frac{B}{④}$ 
 $\frac{P}{⑤}$ 
 $\frac{P}{⑥}$

- ① Series No.
- ② Terminal version: T01= For AWG #26~#30
- ③ Plating code:  
 2= Gold flash plated over 1.27 $\mu$ m(50 $\mu$ "") Nickel  
 A= Selective Gold flash plated over 1.27 $\mu$ m(50 $\mu$ "") Nickel  
 B= Selective 0.38 $\mu$ m(15 $\mu$ "") Gold plated over 1.27 $\mu$ m(50 $\mu$ "") Nickel  
 C= Selective 0.76 $\mu$ m(30 $\mu$ "") Gold plated over 1.27 $\mu$ m(50 $\mu$ "") Nickel
- ④ Material: B= Brass
- ⑤ Plating method: P= Post plating
- ⑥ Type: P= Plug terminal

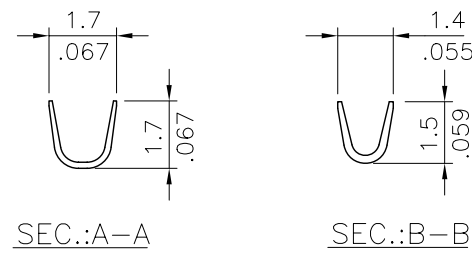

RoHS Compliant

					DATE	UNIT: mm / inch		TITLE: CRIMP TERMINAL		瀚荃股份有限公司 CviLux Corporation			
			DRAWN BY:	Sun	12/03-07'	TOLERANCE UNLESS OTHERWISE SPECIFIED							
			ENGINEER:	Eisley	12/03-07'	.X $\pm$ 0.20/.008	X' $\pm$ 1"	MATERIAL:					
			CHECKED BY:	David	12/03-07'	.XX $\pm$ 0.10/.004	X" $\pm$			FINISH:			
APPROVED BY:	David	12/03-07'	.XXX $\pm$ 0.05/.002	.XX" $\pm$	DRAWING NO.	CD0206SE	PART NO.	CD02T01*BPP					
SYM	NAME	DATE	REVISIONS	APPROVED BY:	DATE	SCALE	5 / 1	SHEET	1 OF 1				